

Proposals for Palm Court Hotel, Torquay

The Palm Court Hotel is situated on an important landmark site on the sea front within the Torbay Council Conservation Area. There is an existing hotel on the site, which was converted from a crescent of Victorian townhouses built in 1858, and later extended in the 1920's with an Art Deco style third floor. It is now in a dilapidated state and Tetlow King negotiated its demolition as part of the proposals.

The existing building is to be replaced with a mixed-use development comprising a new hotel, casino, health spa and bar/ cafe, with residential accommodation to the third and fourth floor. (Estimated construction cost £10 million).

The design of this landmark building was extremely sensitive and was negotiated with English Heritage as well as the local authority Conservation Officer. The proposals are designed in an essentially contemporary style, while making reference to the historical form, symmetry and style of the crescent. The end two houses of the original crescent are in different ownership so the proposed design successfully reconciled these elements within the overall composition.

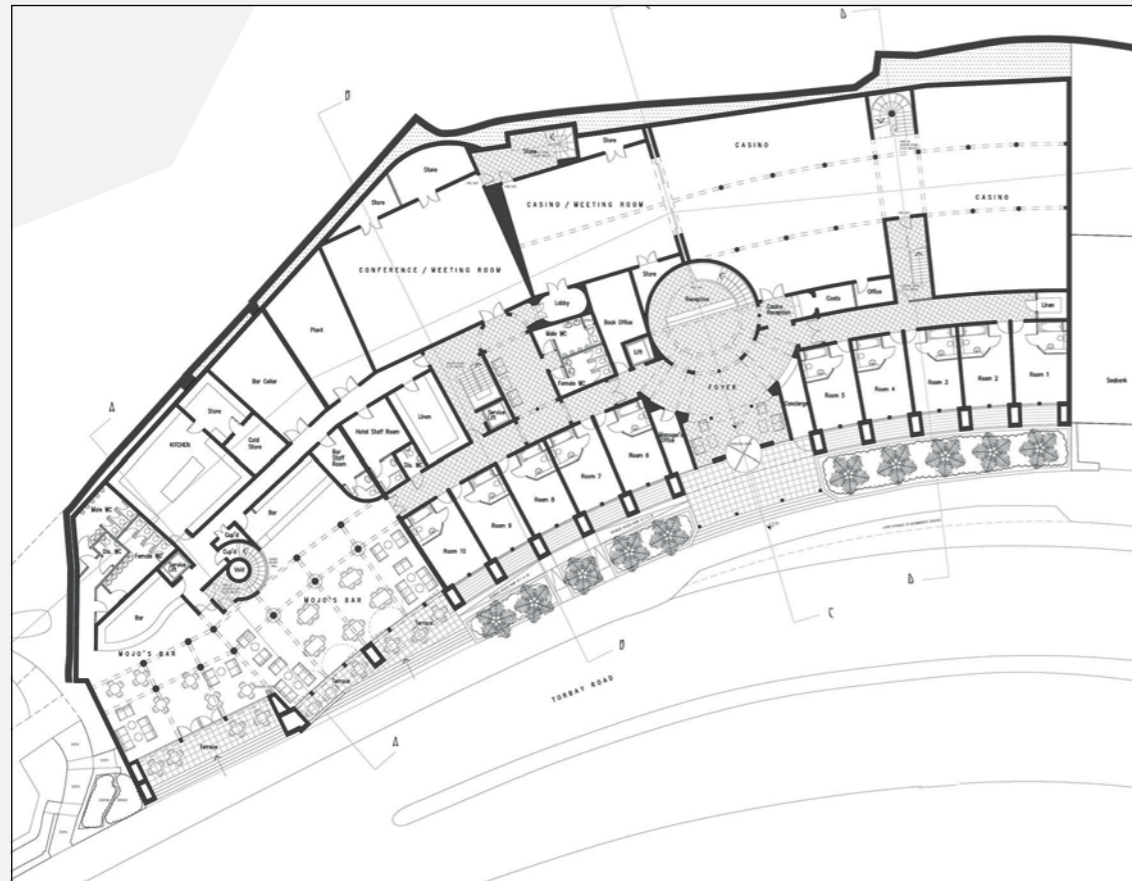

Ground Floor Plan



View of Main Entrance



View of Patio Area